

INSTRUCTION SHEET
HOLLEY CARBURETOR MODEL 2010

NOTE: Bend a paper clip (.030 to .036 dia.) as shown to provide end no longer than 1/8 inch long.

- 1 Insert paper clip into piston bore until end of bore slot is hooked as shown
- 2 Move piston and levers in choke closing direction until edge of piston slot engages paper clip
- 3 Measure distance between lower edge of choke plate and airhorn See Fig. 5
- 4 To Adjust: Bend piston lever tang

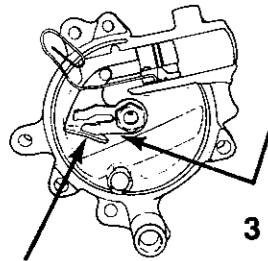

FIG. 6 - CHOKE QUALIFYING (INTEGRAL CHOKE) ADJUSTMENT

Rotate cover to align ref. mark on cover with specified mark on choke housing.

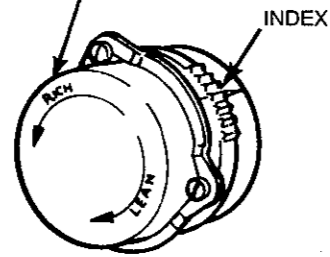

FIG. 7 - CHOKE ADJUSTMENT

- 1 Turn engine off
- 2 Close choke
- 3 Adjust fast idle screw

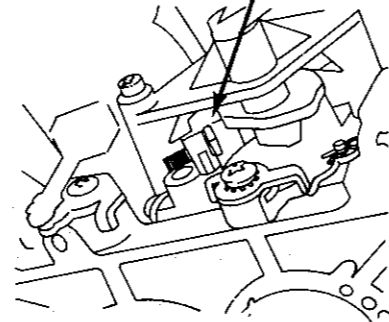

FIG. 8 - FAST IDLE ADJUSTMENT (NON-MARINE ONLY)

Reassembly

Reassemble in reverse order of disassembly. Note special instructions and follow outline in making adjustments. Manually operate the throttle lever and choke mechanism, checking for binding or malfunction. Any binding or interference could cause throttle to stick during operation and result in loss of carburetor throttle control (or uncontrolled engine speed). Check carburetor to be sure there are no leaks, flooding, which might cause a fire.

Special Instructions

Idle Adjusting Needles - Tapered portion of needle must be straight and smooth. If grooved or ridged, a new needle should be installed.

Pump Inlet Check Valve - Lubricate tip of new valve and insert in center hole in pump cavity. Pull through from fuel bowl side until seated.

ADJUSTMENT SPECIFICATIONS

Carburetor Number	Choke Cap Setting	Pump Cam Position	Choke Unloader	Choke Qualify
R82010, R82011, R82012		#1		
R82020, R82021	Index	#1	.300"	.175" -.225"

TYPICAL VIEW

The exploded view shown is typical of the model carburetor this kit will service. The view may differ slightly from the actual carburetor being renewed. This is a universal kit that may contain more parts than are actually required to service a given carburetor. When similar gaskets or parts are included in the kit, compare with original parts.

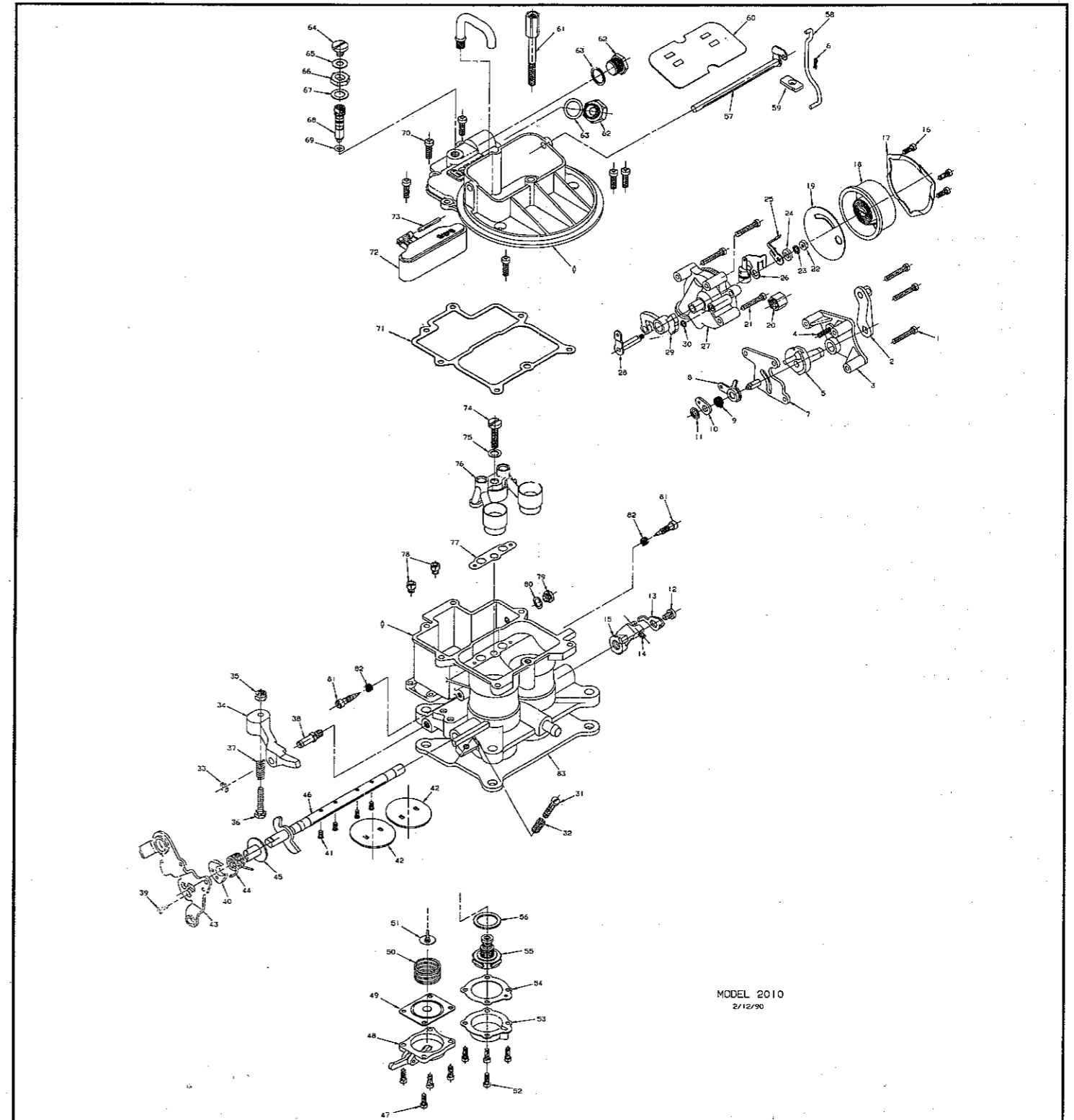

MODEL 2010
2/12/90

- 1. Fast Idle Cam Plate Screw
- 2. Choke Lever and Swivel Assy.
- 3. Fast Idle Cam Plate
- 4. Fast Idle Cam Spring
- 5. Fast Idle Cam
- 6. Choke Rod Retainer
- 7. Choke Lever Back-up Plate
- 8. Choke Rod Lever Hinged
- 9. Choke Spring Ret. Washer
- 10. Choke Spring Ret. Washer
- 11. Push Nut Fastener
- 12. Fast Idle Cam Lever Screw
- 13. Cam Pickup Lever
- 14. Fast Idle Adj. Screw
- 15. Fast Idle Cam Lever
- 16. Thermostat Cap Clamp Screw
- 17. Thermostat Cap Clamp
- 18. Thermostat & Cap Assy. Indexed
- 19. Thermostat Cap Gasket
- 20. Compression Nut
- 21. Choke Housing Screw
- 22. Hex Nut
- 23. Lockwasher
- 24. Choke Thermostat Lever Spacer
- 25. Choke Thermostat Lever
- 26. Thermostat Lever & Piston Assy.
- 27. Choke Housing & Plugs Assy.
- 28. Choke Housing Shaft & Lever Assy.
- 29. Fast Idle Cam Assy.
- 30. Choke Housing Gasket
- 31. Throttle Stop Screw
- 32. Throttle Stop Adj. Screw Spring
- 33. E-Ring Retainer
- 34. Pump Operative Lever Assy.
- 35. Fibre Locking Nut
- 36. Pump Lever Adj. Screw
- 37. Pump Lever Adj. Screw Spring
- 38. Pump Lever Stud
- 39. Pump Cam Screw
- 40. Pump Cam
- 41. Throttle Plate Screw
- 42. Throttle Plate
- 43. Throttle Lever
- 44. Throttle Return Spring
- 45. Throttle Lever Bushing
- 46. Throttle Shaft & Stop Lever Assy.
- 47. Pump Diaphragm Cover Screw
- 48. Accel. Pump Diaphragm Cover Assy.
- 49. Accel. Pump Diaphragm Assy.
- 50. Pump Diaphragm Return Spring
- 51. Air Cleaner Stud
- 52. Fuel Inlet Fitting
- 53. Fuel Inlet Fitting Gasket
- 54. Fuel Valve Cover Gasket
- 55. Power Valve
- 56. Power Valve Gasket
- 57. Choke Shaft & Lever Assy.
- 58. Choke Rod Retainer
- 59. Choke Rod Seal
- 60. Choke Plate
- 61. Fuel Inlet Fitting
- 62. Fuel Inlet Fitting
- 63. Fuel Inlet Fitting Gasket
- 64. Fuel Valve Seat Screw
- 65. Seat Lock Screw Gasket
- 66. Fuel Valve Seat Lock Nut
- 67. Needle & Seat Adj. Nut Gasket
- 68. Fuel Inlet Needle & Seat Assy.
- 69. O-Ring Seal
- 70. Airhorn Screw
- 71. Airhorn Gasket
- 72. Float & Tab Assy.
- 73. Float Shaft
- 74. Nozzle Bar Screw
- 75. Nozzle Bar Screw Gasket
- 76. Nozzle Bar Assy.
- 77. Nozzle Bar Gasket
- 78. Main Jet
- 79. Fuel Level Plug
- 80. Fuel Level Plug Gasket
- 81. Idle Adj. Needle
- 82. Idle Adj. Needle Spring
- 83. Flange Gasket

CARBURETOR ADJUSTMENTS

Disassembly

Rest the carburetor on a repair stand to avoid damage to the throttle plates during renew procedures. Use exploded view as a guide, and follow the numerical sequence in general to disassemble unit far enough to permit cleaning and inspection. Do not remove throttle plates or shaft. Observe and record the initial position of the needle slot. Turn the idle needles clockwise until tightly seated, recording the number of turns required to seat the needles. This procedure is necessary to reinstall the idle needles after renewing.

Cleaning
Cleaning must be done with carburetor disassembled. Soak parts long enough to soften and remove all foreign material. Use a carburetor solvent, lacquer thinner or denatured alcohol. Make certain the throttle body is free of all hard carbon deposits. Wash off in suitable solvent. Blow out all passages in castings with compressed air and check carefully to insure thorough cleaning of obscure areas.
CAUTION: Do not soak parts containing rubber or plastic material. Serious damage could result.

